

Service station locator

The system has been designed to locate the nearest eni service station on the users' route based on GPS data or manually selected.

- **active GPS signal:** the user activates the service which memorises the vehicle's GPS coordinates, the application then provides (textually and visually) directions to the nearest service station.
- **no GPS signal:** the user inputs his current location and the application then provides (textually and visually) directions to the nearest service station.



Service station locator – How it works

1. The application can be used to locate the nearest eni service station or a point of interest indicated by eni by accessing the POI section directly from the Main Menu.
2. To begin a search for a POI eni it is necessary to provide a point of departure, to do this a GPS signal can be used, if available, or the current position can be input manually. The press the “Search” button. For more precise directions, input the exact point of departure (e.g. in the box “Via” “**via Giuseppe Verdi**” rather than just “**G. Verdi**”).
3. The application will also show the nearest points of interest and provides the most significant details, such as the distance. By selecting a point of interest and using the button on the right, the application provides the necessary directions.

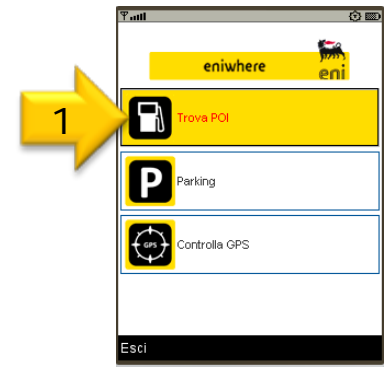

Locate a service station – How it works

- To reach the selected point, follow the indications provided by the application.

By using the “+” and “-” buttons on the right it is possible to see more or less detail on the map in the centre of the screen. The buttons at the top can be used to proceed to the next turning or to go back and see the previous turning.

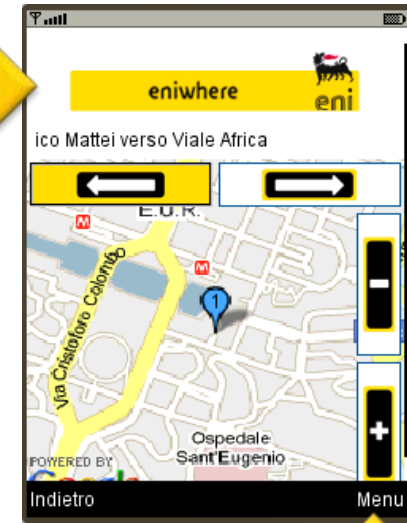

- By clicking on the Menu and “Trip Details” it is possible to get additional information. For more details on the next step of the trip, press “Step”.



GPS support

- The application can make use of an external GPS with a Bluetooth connection.
- The external GPS system must be matched with the application through “GPS control” in the Main Menu.
- Check GPS status or search using Bluetooth to complete the match.
- The external GPS systems must be matched with the users' mobile in line with the manufacturers' indications.
- Access to external GPS systems are provided by Bluetooth API JSR 82. The technical specifications on the users' mobile should be checked.

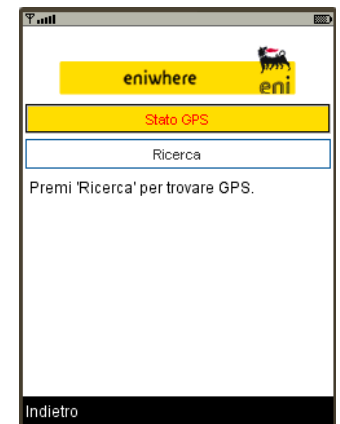
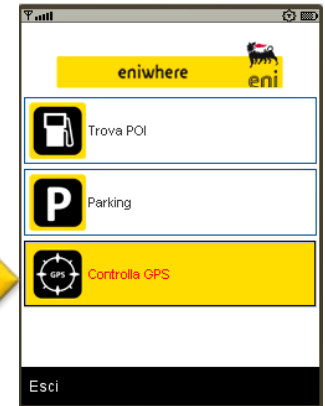

Installation

- Download from browser to mobile.
 - Use the mobile phone browser to access the eni mobile portal and download the application. To install, follow the on-screen instructions.
- Installation from a PC
 - Use the PC browser to access the eni mobile portal and download the application.
 - To install use the methods or specific programs supplied by the manufacturer (e.g. for Nokia mobiles the Nokia PC Suite should be used).

